

High Rate Series LFP1245HR

(12V160Watts/cell@15min.Rate)

FirstPower®

Dimension(mm)

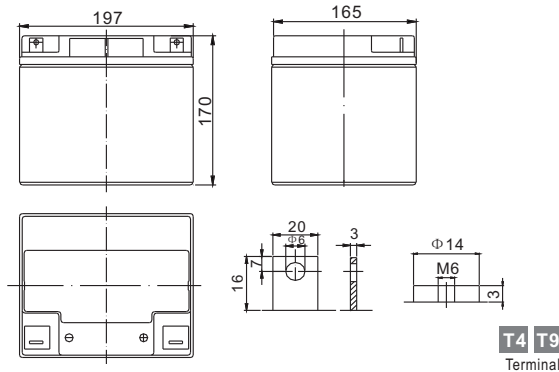

Specification

Nominal Voltage	12 V	
Capacity(10HR, 25°C)	45Ah(160Watts/cell@15min.Rate)	
Dimension	Length	197mm (7.8inch)
	Width	165mm (6.5inch)
	Height	170mm (6.7inch)
	Total Height(T4/T9)	170mm (6.7inch)/170mm (6.7inch)
Approx. Weight	14.5kg (32.0lbs)	

Characteristics

Capacity 20°C (68□) To 1.70V/Cell	20 hour rate	47.6Ah
	10 hour rate	45Ah
	5 hour rate	40.5Ah
	1 hour rate	30Ah
	15 min rate	21.6Ah
Internal resistance(Fully charged, 25°C)	Approx. 7mΩ	
Capacity affected by temperature (10HR)	40°C	102%
	25°C	100%
	0°C	85%
	-15°C	65%
Self-discharge (25°C)	3 month	Remaining Capacity: 91%
	6 month	Remaining Capacity: 82%
	12 month	Remaining Capacity: 65%
Nominal operating temperature	25°C ±3°C(77°F ±5°F)	
Operating temperature range	-15°C ~50°C (5°F ~122°F)	
Float charging voltage(25°C)	13.50 to 13.80V	
Cyclic charging voltage(25°C)	14.50 to 14.90V	
Maximum charging current	13.5A	
Terminal material	Copper	
Maximum discharge current	450A(5 sec.)	

The Relationship for Open Circuit Voltage and Residual Capacity (25°C)

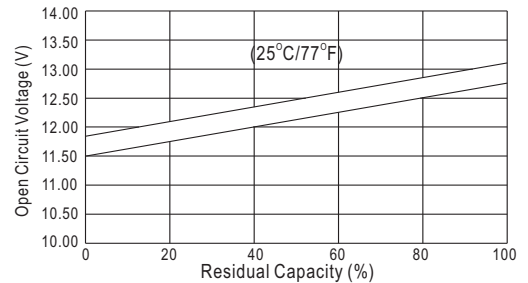

Charging Characteristics(25°C)

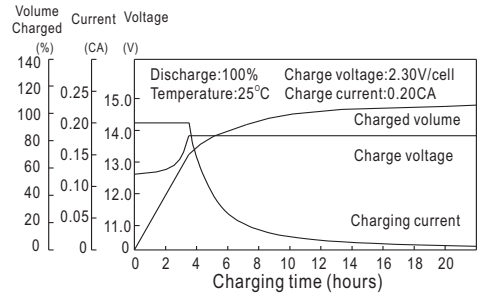

Cycle Life(25°C)

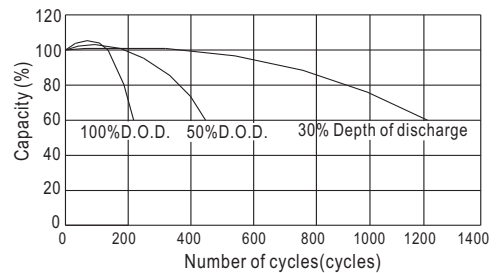

Constant Current Discharge Characteristics (A, 25°C)

F.V/TIME	5min	10min	15min	30min	60min	3h	5h	10h	20h
1.60V/cell	169	111	90.0	51.0	31.3	11.6	8.22	4.57	2.40
1.67V/cell	163	107	87.8	49.8	30.5	11.5	8.15	4.55	2.39
1.70V/cell	160	105	86.4	49.0	30.0	11.5	8.10	4.53	2.38
1.80V/cell	150	99	82.1	46.5	28.5	11.2	7.94	4.50	2.36

Constant Power Discharge Characteristics (Watt/Cell, 25°C)

F.V/TIME	5min	10min	15min	30min	60min	3h	5h	10h	20h
303	205	171	95.4	59.5	22.8	16.2	9.09	4.80	
294	198	167	93.1	58.0	22.6	16.1	9.06	4.78	
288	195	164	91.6	57.1	22.5	16.0	9.01	4.75	
271	183	156	87.0	54.2	22.0	15.6	9.01	4.73	