

LP SERIES-General Purpose

LP4-9.0 (4V9.0AH)

Specification

Nominal Voltage	4V	
Nominal Capacity(20HR)	9.0AH	
Dimension	Length	118±1mm (4.65 inches)
	Width	48±1mm (1.89 inches)
	Container Height	130±1mm (5.12 inches)
	Total Height (with Terminal)	136±1mm (5.35 inches)
Approx Weight	Approx 1.1 kg (2.43lbs)	
Terminal	T1 / T2	
Container Material	ABS	
Rated Capacity	9.00 AH/0.450A	(20hr , 1.80V/cell,25°C/77°F)
	8.37 AH/0.837A	(10hr, 1.80V/cell,25°C/77°F)
	7.65 AH/1.53A	(5hr, 1.75V/cell,25°C/77°F)
	6.90 AH/2.30A	(3hr, 1.75V/cell,25°C/77°F)
	5.65 AH/5.65A	(1hr, 1.60V/cell,25°C/77°F)
Max. Discharge Current	135A (5s)	
Internal Resistance	Approx 9mΩ	
Operating Temp.Range	Discharge	-15~50°C (5~122°F)
	Charge	0~40°C (32~104°F)
	Storage	-15~40°C (5~104°F)
Nominal Operating Temp. Range	25±3°C (77±5°F)	
Cycle Use	Initial Charging Current less than 2.7A. Voltage	
	4.8V~5.0V at 25°C(77°F)Temp. Coefficient -10mV/°C	
Standby Use	No limit on Initial Charging Current Voltage	
	4.5V~4.6V at 25°C(77°F)Temp. Coefficient -6mV/°C	
Capacity affected by Temperature	40°C (104°F)	103%
	25°C (77°F)	100%
	0°C (32°F)	86%
Self Discharge	Leoch LP series batteries may be stored for up to 6 months at 25°C(77°F) and then a freshening charge is required. For higher temperatures the time interval will be shorter.	



Applications

- ◆ All purpose
- ◆ Uninterruptable Power Supply (UPS)
- ◆ Electric Power System (EPS)
- ◆ Emergency backup power supply
- ◆ Emergency light
- ◆ Railway signal
- ◆ Aircraft signal
- ◆ Alarm and security system
- ◆ Electronic apparatus and equipment
- ◆ Communication power supply
- ◆ DC power supply
- ◆ Auto control system



Constant Current Discharge (Amperes) at 25 °C (77°F)

F.V/Time	5min	10min	15min	20min	30min	45min	1h	2h	3h	4h	5h	6h	8h	10h	20h
1.85V/cell	17.1	13.2	10.9	9.43	7.29	5.37	4.53	2.68	2.09	1.70	1.39	1.21	0.972	0.812	0.446
1.80V/cell	23.0	16.8	13.2	11.1	8.60	6.25	5.07	2.92	2.25	1.82	1.49	1.29	1.031	0.837	0.450
1.75V/cell	25.9	18.5	14.4	12.0	8.93	6.48	5.30	3.03	2.30	1.86	1.53	1.33	1.049	0.860	0.455
1.70V/cell	28.6	20.1	15.4	12.6	9.29	6.74	5.47	3.11	2.36	1.91	1.57	1.36	1.063	0.877	0.463
1.65V/cell	31.5	21.7	16.3	13.4	9.80	6.91	5.60	3.15	2.46	1.97	1.61	1.39	1.080	0.895	0.469
1.60V/cell	34.7	23.6	17.5	14.3	10.4	7.20	5.65	3.29	2.53	2.04	1.67	1.41	1.090	0.905	0.472

Constant Power Discharge (Watts) at 25 °C (77°F)

F.V/Time	5min	10min	15min	20min	30min	45min	1h	2h	3h	4h	5h	6h	8h	10h	20h
1.85V/cell	31.3	24.3	20.3	17.8	13.9	10.3	8.73	5.20	4.08	3.33	2.72	2.37	1.92	1.61	0.883
1.80V/cell	41.6	30.7	24.2	20.7	16.1	11.9	9.73	5.64	4.37	3.54	2.91	2.53	2.03	1.65	0.890
1.75V/cell	45.9	33.2	26.2	22.1	16.6	12.2	10.1	5.82	4.43	3.60	2.98	2.59	2.06	1.70	0.898
1.70V/cell	49.2	35.4	27.5	23.0	17.2	12.7	10.4	5.95	4.55	3.69	3.05	2.64	2.09	1.73	0.913
1.65V/cell	53.4	37.8	29.1	24.2	18.0	12.9	10.6	6.01	4.72	3.80	3.12	2.69	2.11	1.76	0.925
1.60V/cell	57.6	40.1	30.6	25.6	18.9	13.4	10.6	6.23	4.84	3.91	3.21	2.74	2.13	1.78	0.929

Dimensions

T1 Terminal

Unit: mm [inches]

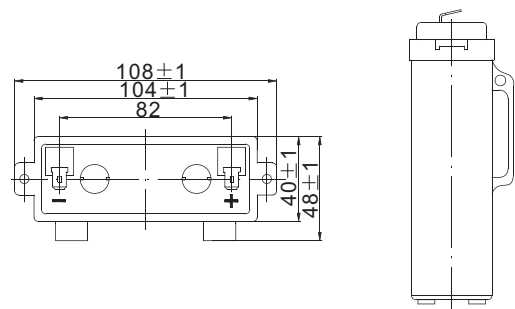
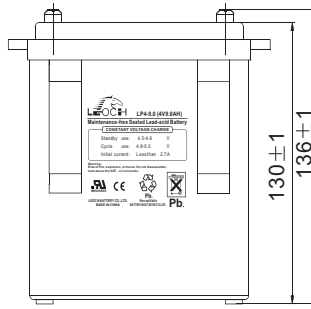
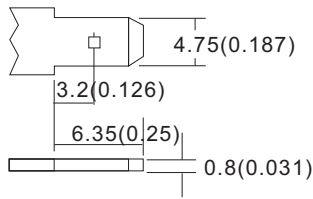

Discharge Characteristics

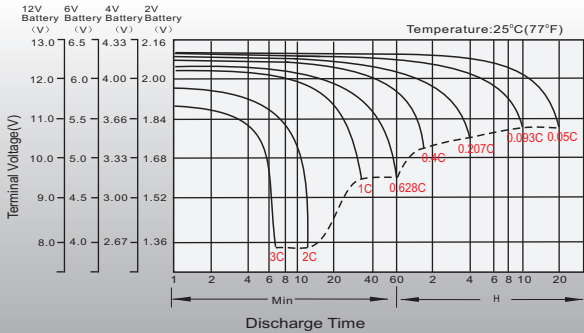

Float Charging Characteristics

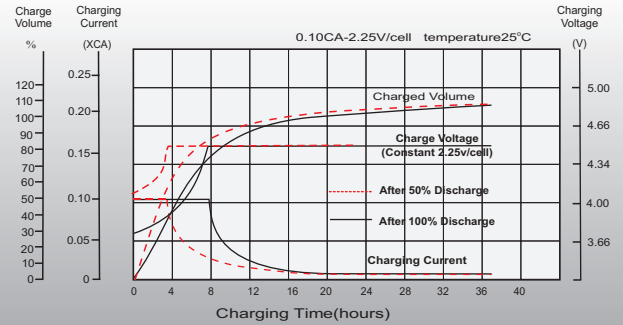

Temperature Effects in Relation to Battery Capacity

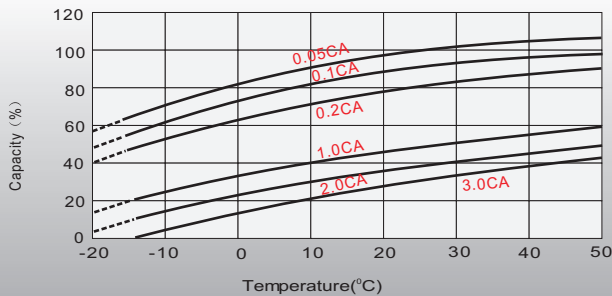

Effect of Temperature on Long Term Float Life

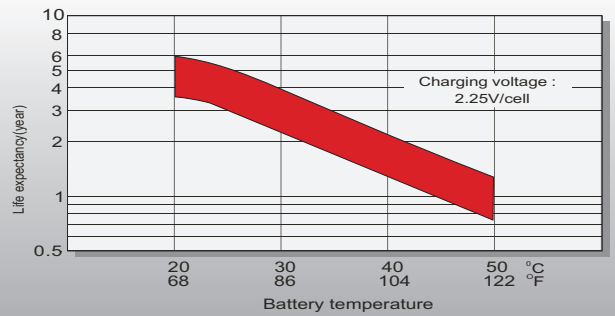

Cycle Life in Relation to Depth of Discharge

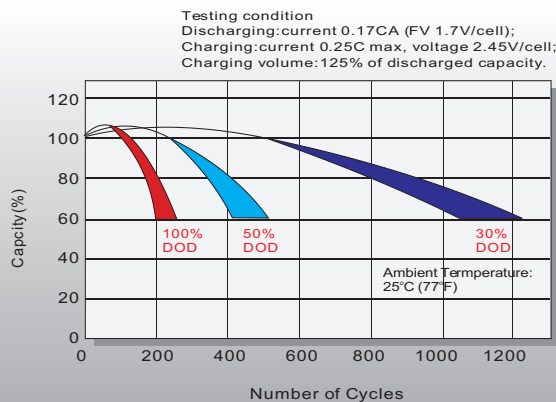

Self Discharge Characteristics

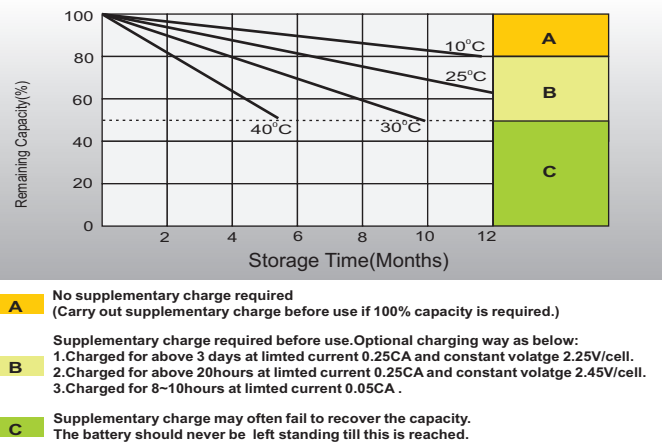

Sales Office

China sales office:

Add: 5th Floor, Xinbaohui Bldg., Nanhai Blvd.,
Nanshan, Shenzhen, China. 518052
Tel: +86-755-86036060 (100 lines)
Fax: +86-755-26067269
E-mail: export@leoch.com
Http://www.leoch.com

North America sales office:

Add: 19751 Descartes, Unit A,
Foothill Ranch, CA 92610, USA
Tel: 949-588-5853
Fax: 949-588-5966
E-mail: sales@leoch.us
Http://www.leoch.us

Europe sales office:

Add: La Campagna House, Main Road,
Gloucester, GL2-8JH, United Kingdom
Tel: +44(0) 1452 751016
E-mail: Sales.Europe@leoch.com
Http://www.leoch.com