

Specification

Nominal Voltage	2V	
Nominal Capacity(10HR)	120.0AH	
Dimension	Length	170±2mm (6.69 inches)
	Width	98±2mm (3.86 inches)
	Container Height	205±2mm (8.07 inches)
	Total Height (with Terminal)	212±2mm (8.35 inches)
Approx Weight	Approx 7.6 kg (16.8lbs)	
Terminal	T7	
Container Material	ABS	
Rated Capacity	126.0 AH/6.30A	(20hr, 1.80V/cell, 25°C/77°F)
	120.0 AH/12.0A	(10hr, 1.80V/cell, 25°C/77°F)
	102.5 AH/20.5A	(5hr, 1.75V/cell, 25°C/77°F)
	90.0 AH/30.0A	(3hr, 1.75V/cell, 25°C/77°F)
	72.0 AH/72.0A	(1hr, 1.60V/cell, 25°C/77°F)
Max. Discharge Current	960A (5s)	
Internal Resistance	Approx 1.3mΩ	
Operating Temp. Range	Discharge	-15~50°C (5~122°F)
	Charge	0~40°C (32~104°F)
	Storage	-15~40°C (5~104°F)
Nominal Operating Temp. Range	25±3°C (77±5°F)	
Cycle Use	Initial Charging Current less than 36.0A. Voltage 2.4V~2.5V at 25°C(77°F)Temp. Coefficient -5mV/°C	
	Standby Use No limit on Initial Charging Current Voltage 2.25V~2.3V at 25°C(77°F)Temp. Coefficient -3mV/°C	
Capacity affected by Temperature	40°C (104°F)	103%
	25°C (77°F)	100%
	0°C (32°F)	86%
Self Discharge	Leoch LP series batteries may be stored for up to 6 months at 25°C(77°F) and then a freshening charge is required. For higher temperatures the time interval will be shorter.	



Applications

- ◆ Tele-communication central station (wired or cellular)
- ◆ Power system communication, military communication, etc.
- ◆ Network communication including: data transmission, television signal transmission, etc.
- ◆ Uninterruptable Power System (UPS- for Telecom)



Constant Current Discharge (Amperes) at 25 °C (77°F)

F.V/Time	5min	10min	15min	20min	30min	45min	1h	2h	3h	4h	5h	6h	8h	10h	20h
1.85V/cell	140.0	123.4	108.4	96.0	80.2	65.2	53.2	35.6	27.2	22.0	18.8	16.5	13.4	11.5	6.08
1.80V/cell	170.4	144.4	123.6	107.6	88.1	70.1	56.7	37.5	29.5	22.7	19.6	17.2	14.1	12.0	6.30
1.75V/cell	199.2	165.4	139.8	119.2	95.9	75.8	61.0	39.8	30.0	24.0	20.5	18.1	14.4	12.2	6.38
1.70V/cell	227.9	187.0	154.5	131.1	104.2	81.0	64.5	42.0	31.3	25.0	21.3	18.7	14.9	12.5	6.52
1.65V/cell	244.7	199.9	164.4	138.6	109.2	84.2	67.1	43.4	32.3	25.7	21.9	19.0	15.2	12.7	6.63
1.60V/cell	283.8	226.4	184.8	154.5	119.4	91.1	72.0	45.5	33.7	26.8	23.0	19.9	15.7	13.2	6.83

Constant Power Discharge (Watts) at 25 °C (77°F)

F.V/Time	5min	10min	15min	20min	30min	45min	1h	2h	3h	4h	5h	6h	8h	10h	20h
1.85V/cell	257.4	229.1	203.4	181.9	153.7	125.9	103.1	69.6	53.4	43.2	37.0	32.7	26.6	22.8	12.1
1.80V/cell	309.9	265.0	228.7	200.9	166.3	134.3	109.3	72.7	57.5	44.4	38.4	33.9	27.8	23.8	12.5
1.75V/cell	354.6	298.8	255.6	220.5	179.4	144.0	117.0	76.8	58.2	46.7	40.1	35.4	28.5	24.3	12.7
1.70V/cell	394.6	330.1	278.6	240.7	193.9	153.3	123.5	81.0	60.7	48.5	41.7	36.6	29.3	24.9	12.9
1.65V/cell	417.7	349.7	294.1	252.5	201.5	157.9	127.4	83.1	62.3	49.8	42.7	37.2	29.8	25.2	13.1
1.60V/cell	473.3	387.1	325.2	278.5	218.9	169.9	136.1	86.9	64.7	51.7	44.5	38.7	30.9	26.0	13.5

Dimensions

T7 Terminal

Unit: mm [inches]

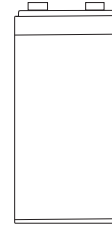
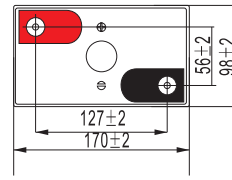
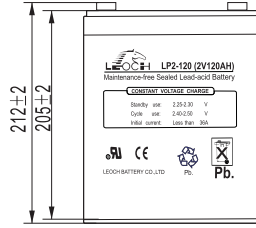
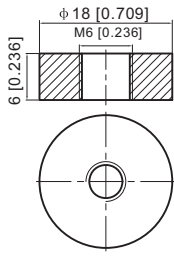

Discharge Characteristics

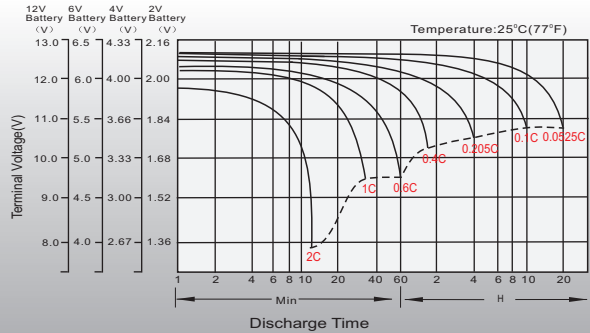

Float Charging Characteristics

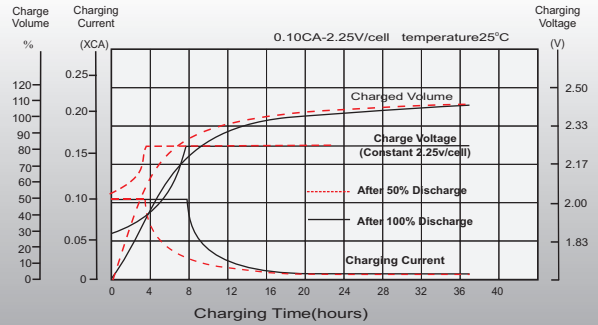

Temperature Effects in Relation to Battery Capacity

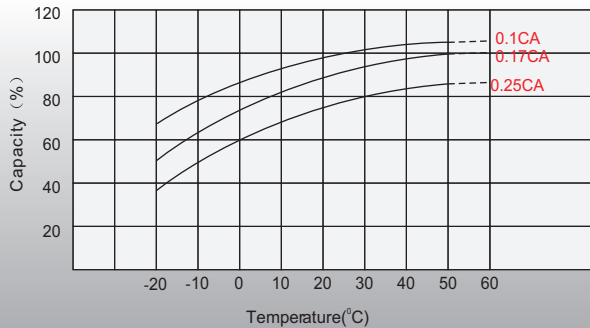

Effect of Temperature on Long Term Float Life

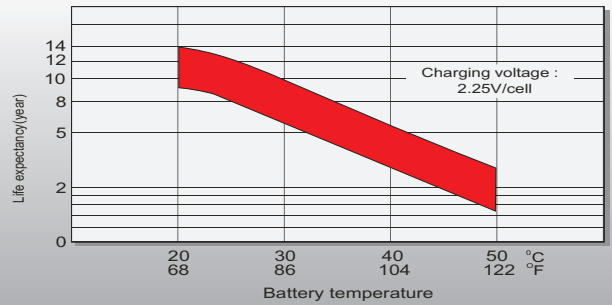

Cycle Life in Relation to Depth of Discharge

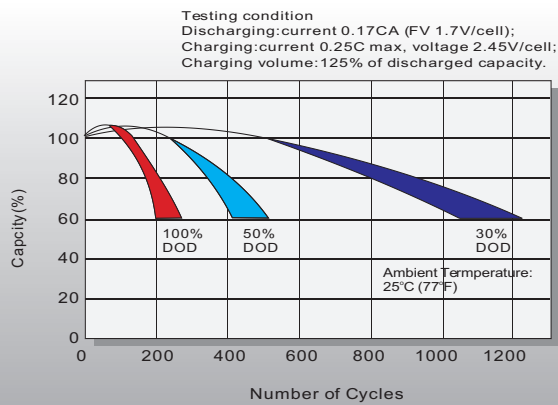

Self Discharge Characteristics

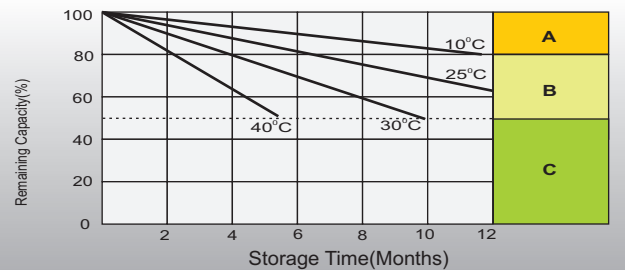

- A** No supplementary charge required (Carry out supplementary charge before use if 100% capacity is required.)
- B** Supplementary charge required before use. Optional charging way as below:
1. Charged for above 3 days at limited current 0.25CA and constant voltage 2.25V/cell.
2. Charged for above 20 hours at limited current 0.25CA and constant voltage 2.45V/cell.
3. Charged for 8-10 hours at limited current 0.05CA.
- C** Supplementary charge may often fail to recover the capacity. The battery should never be left standing till this is reached.

Sales Office

China sales office:

Add: 5th Floor, Xinbaohui Bldg., Nanshan, Shenzhen, China. 518052
Tel: +86-755-86036060 (100 lines)
Fax: +86-755-26067269
E-mail: export@leoch.com
Http://www.leoch.com

North America sales office:

Add: 19751 Descartes, Unit A, Foothill Ranch, CA 92610, USA
Tel: 949-588-5853
Fax: 949-588-5966
E-mail: sales@leoch.us
Http://www.leoch.us

Europe sales office:

Add: La Campagna House, Main Road, Gloucester, GL2-8JH, United Kingdom
Tel: +44(0) 1452 751016
E-mail: Sales.Europe@leoch.com
Http://www.leoch.com