

### Specification

Nominal Voltage	12V	
Nominal Capacity(8HR)	72.0AH	
Dimension	Length	259±2mm (10.20 inches)
	Width	168±2mm (6.61 inches)
	Container Height	208±2mm (8.19 inches)
	Total Height (with Terminal)	214±2mm (8.43 inches)
	Approx Weight	Approx 21.0 kg (46.3lbs)
Terminal	T6 / T14	
Container Material	ABS	
Rated Capacity	73.3 AH/7.33A	(10hr, 1.80V/cell, 25°C/77°F)
	72.0 AH/9.00A	(8hr, 1.75V/cell, 25°C/77°F)
	64.1 AH/12.02A	(5hr, 1.75V/cell, 25°C/77°F)
	58.3 AH/19.445A	(3hr, 1.75V/cell, 25°C/77°F)
	47.3 AH/47.3A	(1hr, 1.60V/cell, 25°C/77°F)
Max. Discharge Current	864A (5s)	
Internal Resistance	Approx 6.6mΩ	
Operating Temp. Range	Discharge	-15~50°C (5~122°F)
	Charge	0~40°C (32~104°F)
	Storage	-15~40°C (5~104°F)
Nominal Operating Temp. Range	25±3°C (77±5°F)	
Cycle Use	Initial Charging Current less than 21.6A. Voltage	
	14.4V~15.0V at 25°C(77°F) Temp. Coefficient -30mV/°C	
Standby Use	No limit on Initial Charging Current Voltage	
	13.5V~13.8V at 25°C(77°F) Temp. Coefficient -20mV/°C	
Capacity affected by Temperature	40°C (104°F)	103%
	25°C (77°F)	100%
	0°C (32°F)	86%
Self Discharge	Leoch LPX series batteries may be stored for up to 6 months at 25°C(77°F) and then a freshening charge is required. For higher temperatures the time interval will be shorter.	



### Applications

- ◆ UPS (High rate)
- ◆ High power backup supply
- ◆ Emergency power supply
- ◆ Starting system
- ◆ Power tools
- ◆ Emergency lighting
- ◆ Electric starting

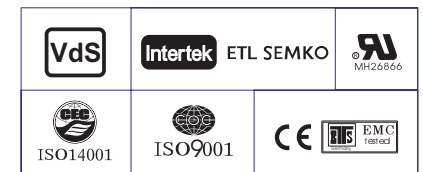

### Constant Current Discharge (Amperes) at 25 °C (77°F)

F.V/Time	5min	10min	15min	20min	30min	45min	1h	2h	3h	4h	5h	6h	8h	10h	20h
1.85V/cell	138.0	106.4	89.9	78.6	58.3	44.4	36.6	22.9	17.7	14.2	11.6	10.1	8.34	6.92	3.86
1.80V/cell	185.2	136.0	108.6	92.9	68.8	51.7	41.0	25.0	19.1	15.1	12.5	10.8	8.85	7.33	3.90
1.75V/cell	208.9	149.4	118.6	99.9	71.4	53.6	42.8	26.0	19.4	15.5	12.8	11.1	9.00	7.40	3.94
1.70V/cell	230.0	162.8	126.6	105.0	74.3	55.8	44.2	27.0	20.0	15.9	13.1	11.3	9.13	7.47	4.01
1.65V/cell	253.6	175.8	134.6	111.5	78.4	57.2	45.7	27.8	20.8	16.4	13.5	11.6	9.27	7.63	4.06
1.60V/cell	279.7	190.8	144.0	118.8	82.8	59.6	47.3	28.7	21.5	17.0	14.0	11.8	9.36	7.71	4.08

### Constant Power Discharge (Watts) at 25 °C (77°F)

F.V/Time	5min	10min	15min	20min	30min	45min	1h	2h	3h	4h	5h	6h	8h	10h	20h
1.85V/cell	252.3	196.6	167.7	148.1	111.1	85.4	70.5	44.5	34.6	27.7	22.8	19.8	16.5	13.7	7.65
1.80V/cell	335.1	248.2	199.9	172.5	129.1	98.6	78.6	48.3	37.0	29.5	24.4	21.1	17.4	14.5	7.72
1.75V/cell	369.8	268.4	215.7	183.7	133.0	101.3	81.8	49.9	37.5	30.0	24.9	21.6	17.7	14.6	7.78
1.70V/cell	395.9	285.9	227.0	191.7	137.6	105.0	84.1	51.8	38.5	30.7	25.5	22.1	17.9	14.7	7.92
1.65V/cell	430.4	305.7	239.6	202.1	144.0	106.6	86.3	52.9	40.0	31.7	26.1	22.5	18.1	15.0	8.01
1.60V/cell	463.7	324.3	252.0	212.9	150.9	110.5	88.9	54.4	41.0	32.6	26.9	22.9	18.3	15.2	8.04

## Dimensions

### T6 Terminal

Unit: mm [inches]

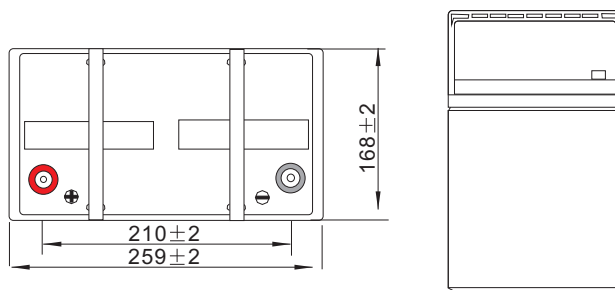
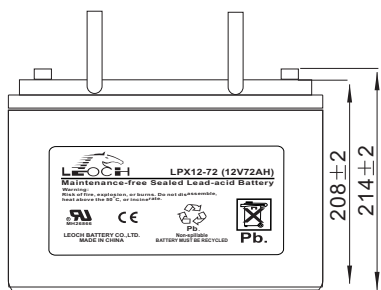
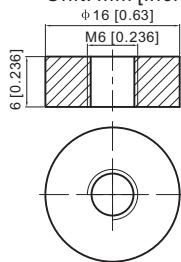

## Discharge Characteristics

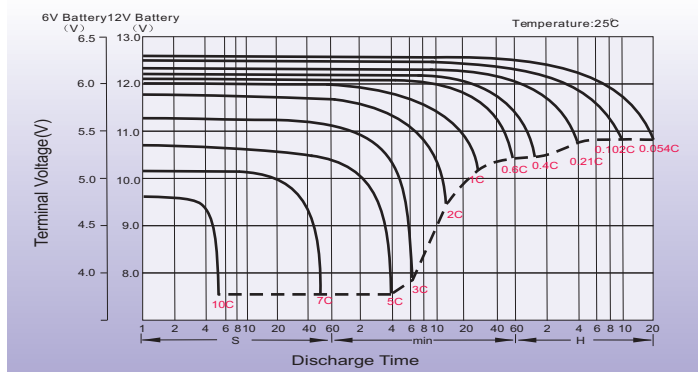

## Float Charging Characteristics

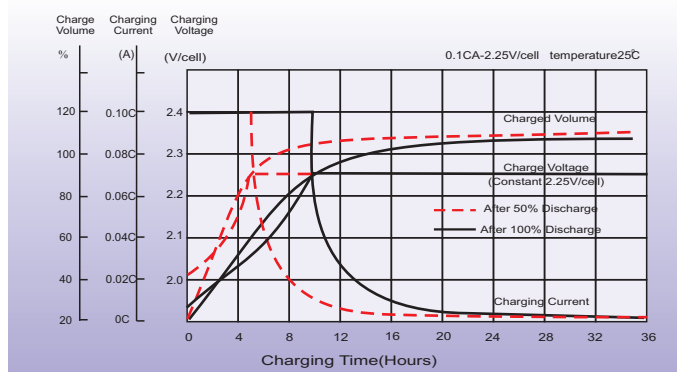

## Temperature Effects in Relation to Battery Capacity

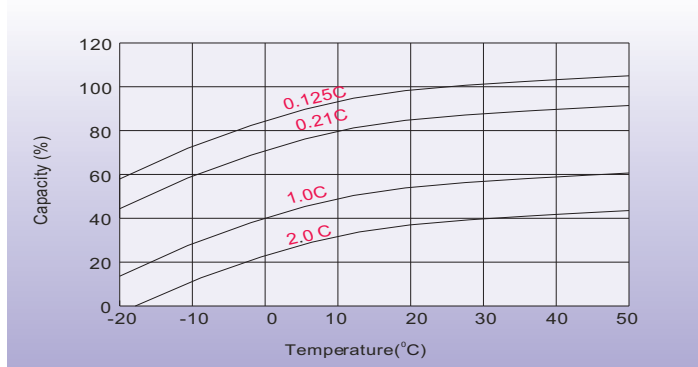

## Effect of Temperature on Long Term Float Life

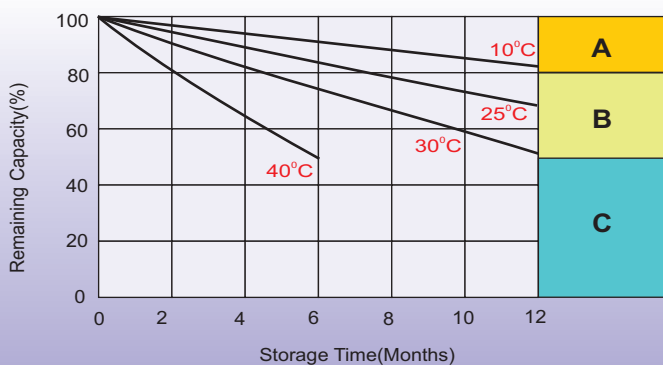
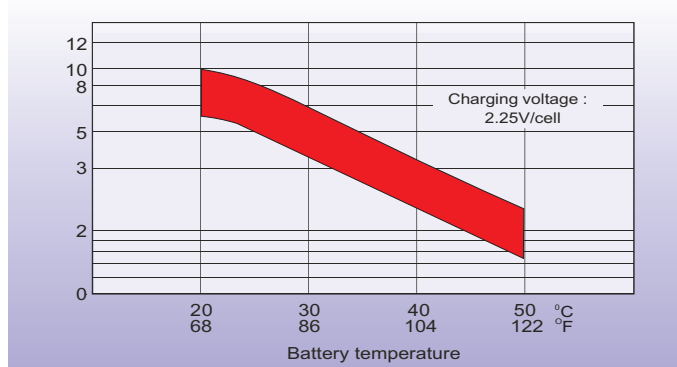

## Self Discharge Characteristics

- A** No supplementary charge required  
(Carry out supplementary charge before use if 100% capacity is required.)
- B** Supplementary charge required before use. Optional charging way as below:
  1. Charged for above 3 days at limited current 0.25CA and constant voltage 2.25V/cell.
  2. Charged for above 20 hours at limited current 0.25CA and constant voltage 2.45V/cell.
  3. Charged for 8-10 hours at limited current 0.05CA.
- C** Supplementary charge may often fail to recover the capacity.  
The battery should never be left standing till this is reached.

## Sales Office

### China sales office:

Add: 5th Floor, Xinbaohui Bldg., Nanhai Blvd.,  
Nanshan, Shenzhen, China. 518052  
Tel: +86-755-86036060 (100 lines)  
Fax: +86-755-26067269  
E-mail: export@leoch.com  
Http://www.leoch.com

### North America sales office:

Add: 19751 Descartes, Unit A,  
Foothill Ranch, CA 92610, USA  
Tel: 949-588-5853  
Fax: 949-588-5966  
E-mail: sales@leoch.us  
Http://www.leoch.us

### Europe sales office:

Add: La Campagna House, Main Road,  
Gloucester, GL2-8JH, United Kingdom  
Tel: +44(0) 1452 751016  
E-mail: Sales.Europe@leoch.com  
Http://www.leoch.com