

LPF SERIES-Front Terminal

LPF12-125 (12V125AH)



Specification

Nominal Voltage	12V	
Nominal Capacity(8HR)	125.0AH	
Dimension	Length	551 ± 2mm (21.69 inches)
	Width	110 ± 2mm (4.33 inches)
	Container Height	287 ± 2mm (11.30 inches)
	Total Height (with Terminal)	287 ± 2mm (11.30 inches)
Approx Weight	Approx 40.5 Kg (89.3 lbs)	
Terminal	T6	
Container Material	ABS	
Rated Capacity	137.4 AH/6.87A	(20hr, 1.80V/cell, 25°C/77°F)
	129.7 AH/12.98A	(10hr, 1.80V/cell, 25°C/77°F)
	125.0 AH/15.63A	(8hr, 1.80V/cell, 25°C/77°F)
	118.1 AH/23.62A	(5hr, 1.75V/cell, 25°C/77°F)
	86.5 AH/86.5A	(1hr, 1.67V/cell, 25°C/77°F)
Max. Discharge Current	1100A (5s)	
Internal Resistance	Approx 3.2mΩ	
Operating Temp. Range	Discharge	-15 ~ 50°C (5 ~ 122°F)
	Charge	0 ~ 40°C (32 ~ 104°F)
	Storage	-15 ~ 40°C (5 ~ 104°F)
Nominal Operating Temp. Range	25 ± 3°C (77 ± 5°F)	
Cycle Use	Initial Charging Current less than 37.5A. Voltage	
	14.4V ~ 15.0V at 25°C (77°F) Temp. Coefficient -30mV/°C	
Standby Use	No limit on Initial Charging Current Voltage	
	13.5V ~ 13.8V at 25°C (77°F) Temp. Coefficient -20mV/°C	
Capacity affected by Temperature	40°C (104°F)	103%
	25°C (77°F)	100%
	0°C (32°F)	86%
Self Discharge	Leoch LPF series batteries may be stored for up to 6 months at 25°C (77°F) and then a freshening charge is required. For higher temperatures the time interval will be shorter.	

Applications

- ◆ For standard 19 inches or 23 inches power cabinets
- ◆ Network connection equipment of communication system
- ◆ Power system of special network or local area network
- ◆ UPS, standby power supply
- ◆ Power station systems
- ◆ Railway and marine systems



Constant Current Discharge (Amperes) at 25 °C (77°F)

F.V/Time	10min	15min	20min	30min	45min	1h	2h	3h	4h	5h	6h	8h	10h	20h
1.85V/cell	217.4	181.2	155.5	122.0	94.6	76.9	45.9	33.0	26.5	21.9	19.1	14.87	12.41	6.57
1.80V/cell	246.5	202.0	172.1	133.5	101.8	82.1	48.4	35.1	27.9	23.1	20.1	15.63	12.98	6.87
1.75V/cell	270.5	218.6	183.7	140.3	105.7	85.0	49.3	35.7	28.6	23.6	20.4	15.81	13.13	6.98
1.70V/cell	289.3	230.2	191.1	144.4	108.1	86.1	50.0	36.1	28.8	23.8	20.6	16.04	13.25	7.03
1.67V/cell	299.4	236.0	195.0	146.2	108.5	86.5	50.1	36.3	29.0	24.0	20.9	16.25	13.38	7.06
1.60V/cell	314.7	245.0	203.8	149.9	111.4	88.8	51.0	37.0	29.6	24.6	21.3	16.63	13.63	7.10

Constant Power Discharge (Watts) at 25 °C (77°F)

F.V/Time	10min	15min	20min	30min	45min	1h	2h	3h	4h	5h	6h	8h	10h	20h
1.85V/cell	405.9	341.8	296.3	234.9	183.7	149.9	90.0	65.0	52.4	43.5	37.9	29.7	24.8	13.15
1.80V/cell	454.8	375.8	323.1	253.2	196.1	159.1	94.3	68.8	54.8	45.5	39.7	31.1	25.9	13.73
1.75V/cell	491.2	401.8	341.6	263.9	201.7	164.0	95.7	69.6	56.0	46.4	40.2	31.4	26.2	13.92
1.70V/cell	513.7	417.4	352.7	270.1	205.6	165.7	96.9	70.2	56.3	46.5	40.6	31.8	26.4	14.01
1.67V/cell	529.5	426.0	358.5	273.0	205.6	166.0	97.0	70.4	56.6	47.0	41.0	32.2	26.6	14.07
1.60V/cell	541.3	433.6	369.3	276.2	208.8	168.6	97.8	71.4	57.5	48.0	41.6	32.8	27.1	14.12

Dimensions

T6 Terminal

Unit: mm [inches]

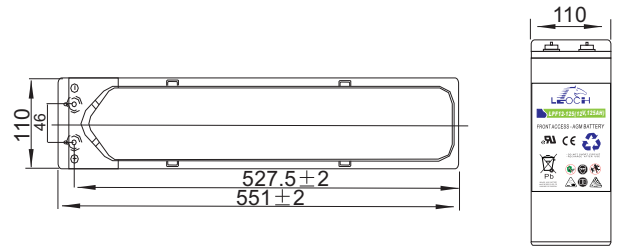
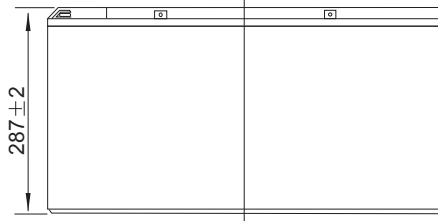
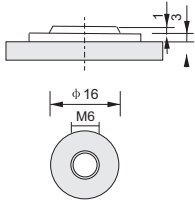

Discharge Characteristics

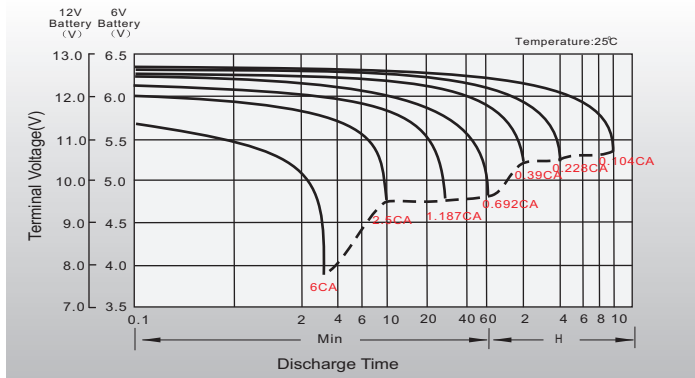

Float Charging Characteristics

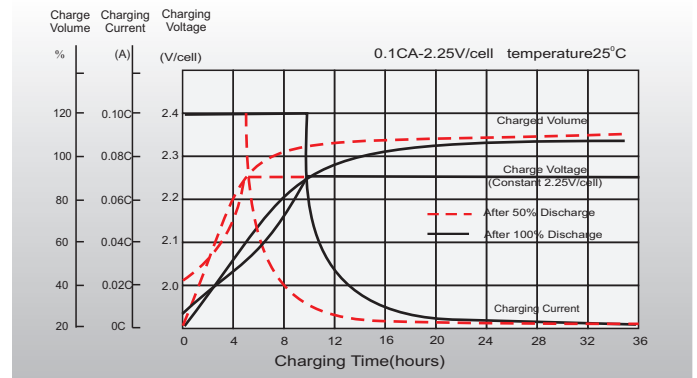

Temperature Effects in Relation to Battery Capacity

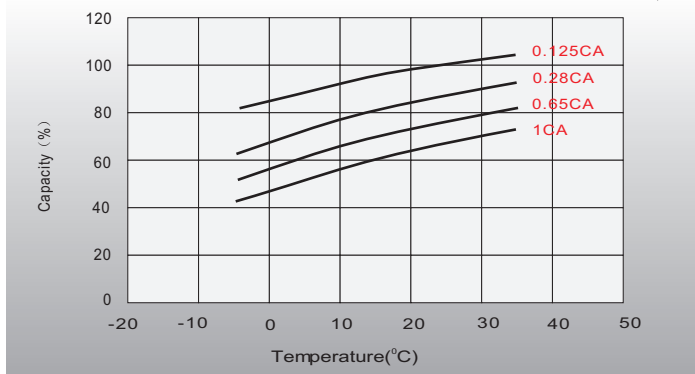

Effect of Temperature on Long Term Float Life

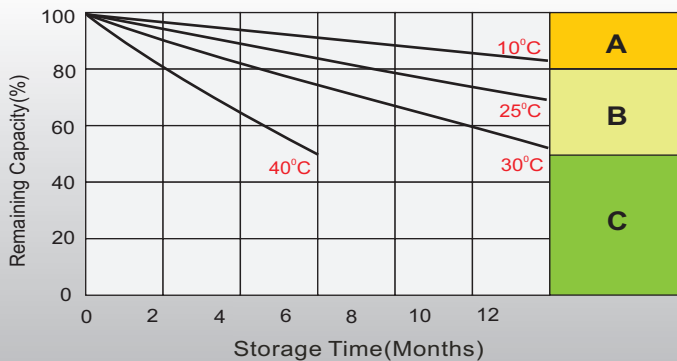
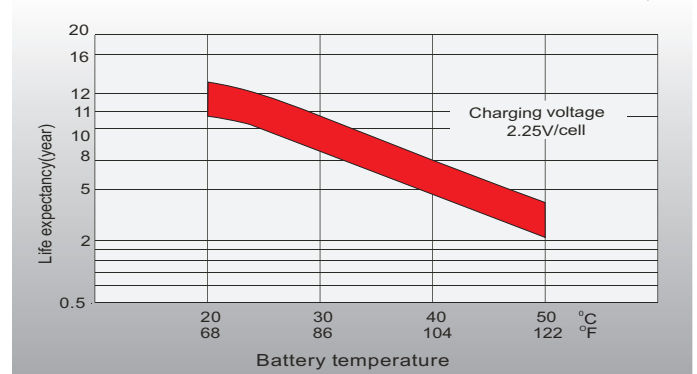

Self Discharge Characteristics

- A** No supplementary charge required
(Carry out supplementary charge before use if 100% capacity is required.)
- B** Supplementary charge required before use. Optional charging way as below:
 1. Charged for above 3 days at limited current 0.25CA and constant volatge 2.25V/cell.
 2. Charged for above 20hours at limited current 0.25CA and constant volatge 2.45V/cell.
 3. Charged for 8~10hours at limited current 0.05CA .
- C** Supplementary charge may often fail to recover the capacity.
The battery should never be left standing till this is reached.

Sales Office

China sales office:

Add: 5th Floor, Xinbaohui Bldg., Nanhai Blvd.,
Nanshan, Shenzhen, China. 518052
Tel: + 86-755-86036060 (100 lines)
Fax: +86-755-26067269
E-mail: export@leoch.com
Http://www.leoch.com

North Americasales office:

Add: 19751 Descartes, Unit A,
Foothill Ranch, CA 92610, USA
Tel: 949-588-5853
Fax: 949-588-5966
E-mail: sales@leoch.us
Http://www.leoch.us

Europe sales office:

Add: LaCampa House. Main Road.
Gloucester. GL2-8JH. United Kingdom
Tel: +44(0) 1452 751016
E-mail: Sales.Europe@leoch.com
Http://www.leoch.com

